



# POLAR 1000®

LAMP COMPARTMENT  
**IP 20**  
 LAMP COMPARTMENT  
 with item NX 5005  
**IP 55**   
 ELECTRIC COMPARTMENT  
**IP 20**



## RANGE

Accommodates 1000W HPS, and MBI lamps.

## APPLICATIONS

Used for requirements of excellent horizontal and vertical illumination such as warehouses, gymnasiums, automotive and truck service areas, manufacturing plants, foundries, and retail spaces.

## CONSTRUCTION

Polar 1000® has a gear compartment made out of heavy die cast aluminium, and finished with a corrosive resistant powder coated polyester black paint that can withstand extreme temperature variations. The E40 lampholder is mounted onto a regulation device which allows the reflector to emit six different distribution patterns. Polar 1000® comes with a 99.8% purity aluminium polished and anodized reflector. The reflector produces a wide uniform light distribution with minimum glare.

## ELECTRICAL

Control gear is rated 230V or 240V 50Hz as standard. HPS and MBI circuits are fitted with superimposed pulse electronic ignitors as standard, minimizing the possibility of ballast failure in prolonged operation with a failed lamp inserted. A three pole terminal block for mains connection is provided. High temperature silicon insulated conductors are used throughout.

## MECHANICAL

Polar 1000® can either be directly mounted on the ceiling or suspended thanks to the special balancing device supplied. The power supply enters through a PG 13.5 cable gland. The body can be fully opened up and the gear tray completely removed, this guarantees a simple and rapid maintenance operation.

## SPECIFICATION

Designed in accordance with the following Standards: CEI 34-21 and EN60598-1.

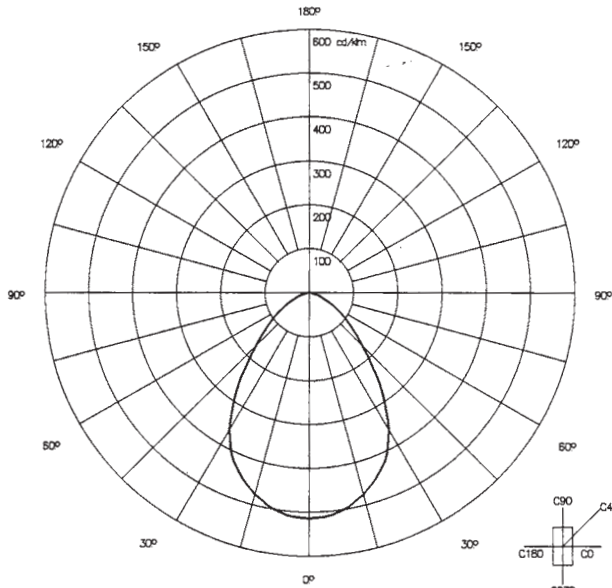
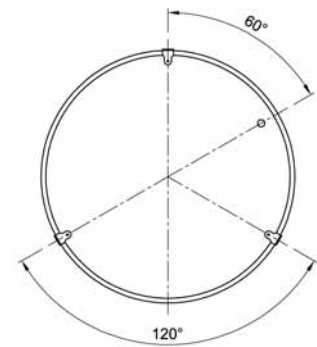
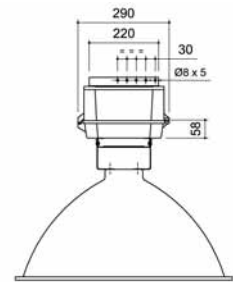
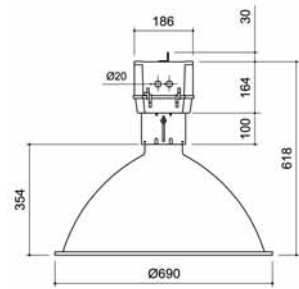

MBI 1000W

## ORDERING DATA

CODE N°	LAMP	LAMP HOLDER	WEIGHT KG
NX 5026	EMPTY	E40	10,50
NX 5033	1000 W MBI	E40	16,60
NX 5043	1000 W HPS	E40	16,60
01 0 0077 0	SPARE PC REFLECTOR		2,41
NX 5005	TEMPERED GLASS		2,70